

# BROMMA TWISTLOCK WITH INTEGRATED LOAD SENSOR

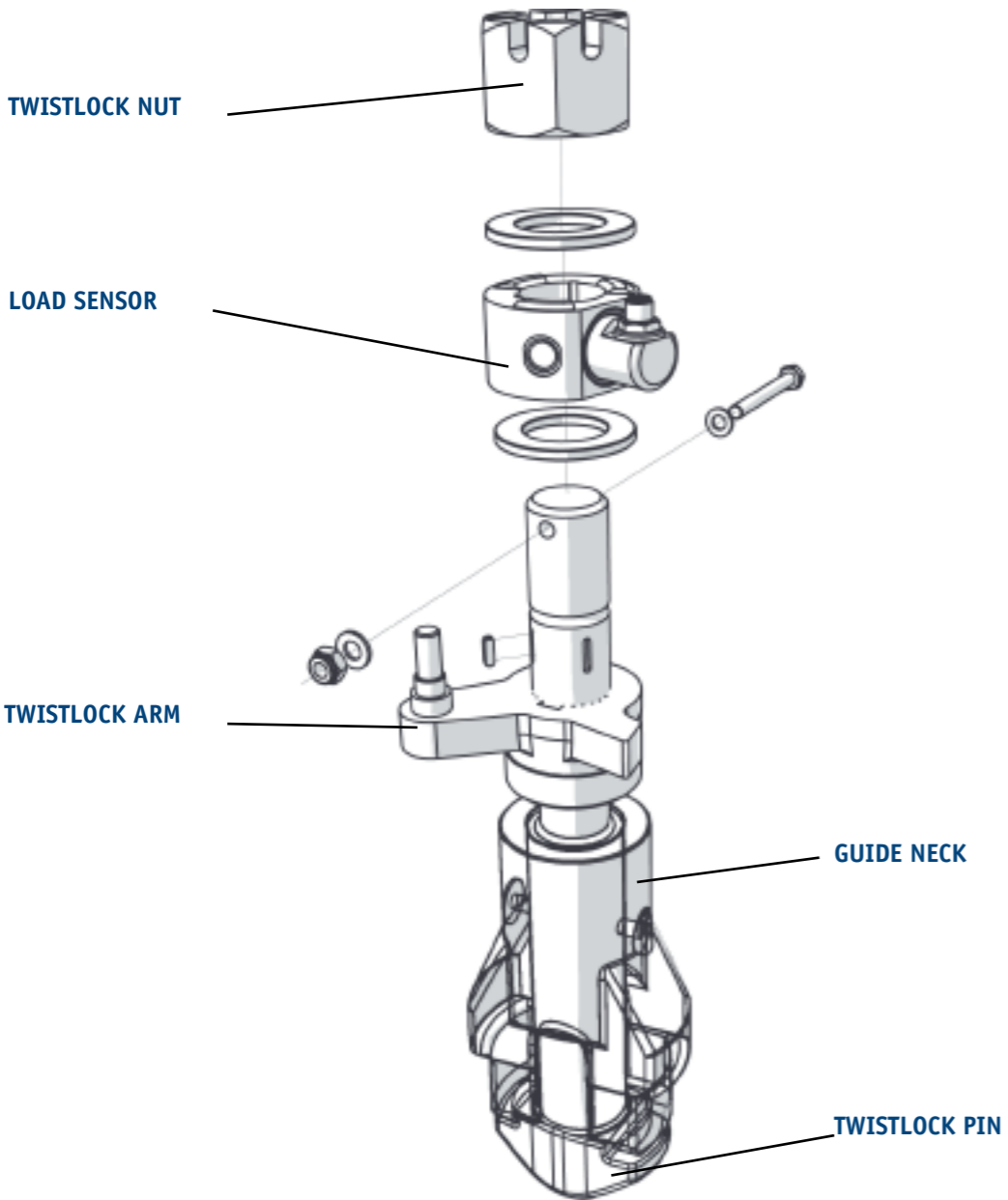

**PERFORM A SAFER LIFT**



# LOAD SENSING SYSTEM

**- Protect Worker Safety. Reduce Commercial Risk**

Mis-declaration of container weights is a significant risk issue in the container handling industry. The new Bromma load sensing system offers a simple way to reduce commercial risk and, even more importantly, protect worker safety. Bromma spreaders outfitted with load sensing technology at the spreader twistlocks will: Verify container weights. Identify container overloads or understatement of container weight – a well-known terminal safety risk.

Identify *out-of-balance* eccentric loads – an equally important operational risk. Perform load sensing without any interruption to normal port processes and without any less-ening of port productivity. Identify when containers are lifted by yard cranes from the trailer truck while one or more corners of the chassis remain connected to the container.

## ALWAYS PERFORM A SAFER LIFT

Whatever the economic climate, safety remains a top priority at container terminals. Recognizing this, Bromma, the world's leading crane spreader company, has expanded its spreader safety products portfolio with a new load sensing system

for the spreader twistlocks. Maximizing safety in container handling operations is a core engineering value at Bromma, which is why load sensing technology is being adopted. Your safety is our concern.

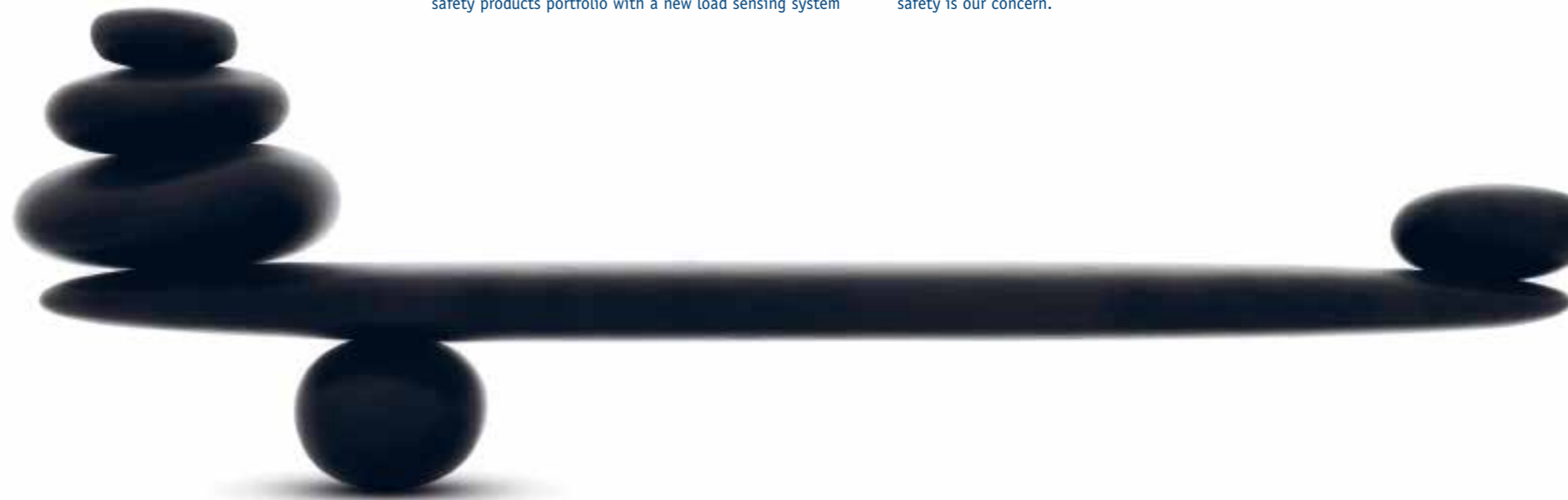

### KEY BENEFITS

#### » WEIGHT DATA

Measure the exact load of each twistlock and the total container weight.

#### » PREVENT DANGEROUS ACCIDENTAL LIFT

Prevent accidental lifts when containers lifted from the truck remain connected to the container.

### WORKER SAFETY ALWAYS COMES FIRST

Bromma is a serious company -- serious about spreader performance and serious about our safety and environmental commitments.

#### » DETECT OVERLOAD

Reduce commercial risk and, even more importantly, protect worker safety

#### » MEASURE ECCENTRICITY

Observe container load eccentricity in both single and twin-lift mode.

At Bromma, safety isn't an afterthought – it's a first thought which is why worker safety always plays a strong role in our spreader design decisions.

#### » TWISTLOCK LIFE CYCLE CALCULATION

Replace the twistlocks as needed based on cycle calculation; you never have to replace the sensors.

#### » STANDARDIZATION

Fits all Bromma spreader models.

Bromma understands container handling. We understand the risks and the commercial pressures in our industry, and we understand the importance of accident prevention.

Bromma load sensing: it gives you the knowledge to always perform a safer lift.